



# FISCHER LP360™ LED

## INCREASED SECURITY, VISIBILITY AND IDENTIFICATION

- Easy mating with LP360™ plug & use technology
- IP68 sealed to 20m/24h
- Lightweight, compact and low-profile



# KEY FEATURES

Plug & use LED utilizing breakthrough LP360™ technological innovations in mating (360° mating freedom, no key code), material (membrane-sealed contacts for easy cleaning as well as protection from dust & sand) and integration (low-

profile, direct panel plug integration into device's housing) for maximum usability, operability and functionality. Also designed to give immediate visual indication for power testing.

## AVAILABLE SIZE 1:1

## TECHNICAL DIMENSIONS

### Fischer LP360™ LED

| BODY STYLE       | LED           |
|------------------|---------------|
| Sealing (mated)  | IP68          |
| Locking system   | Quick-release |
| Contact          | Spring-loaded |
| Housing material | Brass         |
| Housing color    | Anthracite    |
| Size             | 14            |
| Weight           | 24 g          |

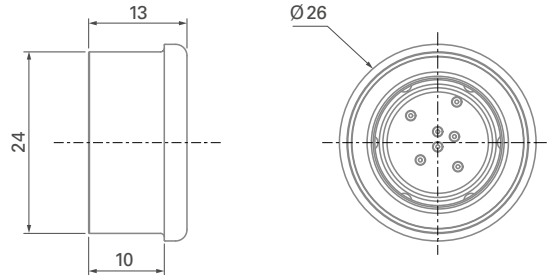

| Active Device | Designation | Part No. |
|---------------|-------------|----------|
| LED           | -           | 133353   |

### ENVIRONMENTAL, MECHANICAL & ELECTRICAL DATA

|                             | Performance                             | Method                                |
|-----------------------------|---|---------------------------------------|
| Sealing performance (mated) | IP68<br>20m/24h                         | MIL-STD-810<br>Method 512.6           |
| Operating temperature       | -55 °C to +85 °C                        | MIL-STD-810<br>Method 501.6 and 502.6 |
| Corrosion resistance        | 1,000 h at 5 % salt and 35 °C           | MIL-STD-810G Method 509.6             |
| Vibration                   | 9.26 G <sub>rms</sub>                   | MIL-STD-202 Method 214 Condition I    |
| Endurance                   | 10,000 mating cycles<br>5,000 rotations | IEC 60512-9-1                         |

### CONTACT CONFIGURATION

|             |   |
|-------------|---|
| VCC (power) | 6 |
| D-          | 7 |
| D+          | 2 |
| GND         | 1 |

### ALSO AVAILABLE



LP360™  
USB 2.0 adaptor



LP360™  
Rugged Flash Drive

### INTERFACES

| Fischer Freedom™ Series |             |                                  |          |
|-------------------------|-------------|----------------------------------|----------|
| <b>FLR01</b>            |             |                                  |          |
|                         | Designation |                                  | Part No. |
|                         | Size<br>14  | FLR01WZZ14 T007P AN360 V3AC      | 132506   |
| <b>FLR50</b>            |             |                                  |          |
|                         | Designation |                                  | Part No. |
|                         | Size<br>14  | CA S 07 FR50Z14B B/OE BRA PUR TN | 134999   |



For more information visit  
[fischerconnectors.com/lp360](https://www.fischerconnectors.com/lp360)