

SS/SSC 105 Multipole Plugs

All dimensions see note 1)

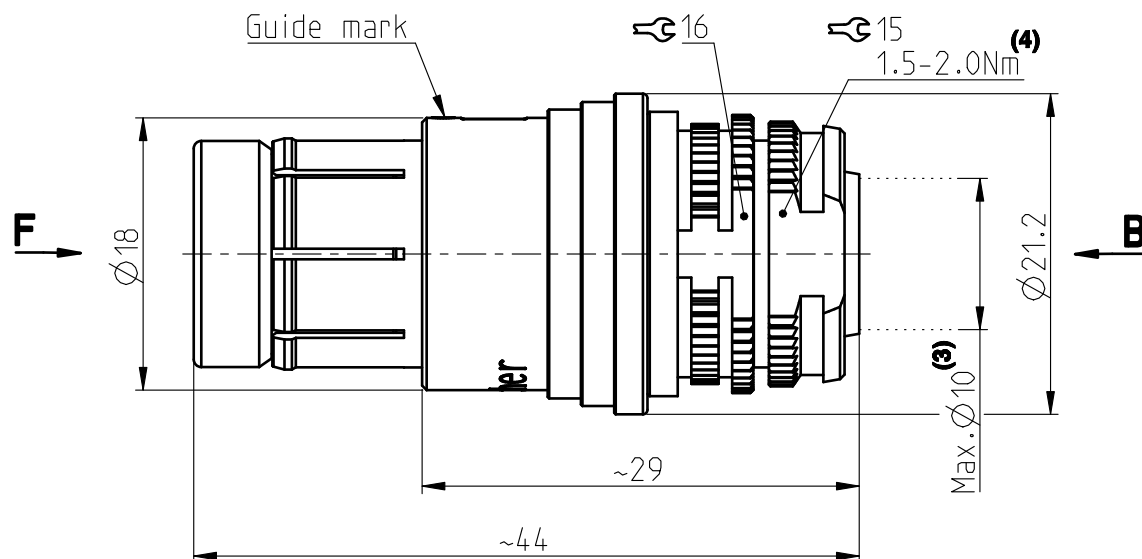

Contact polarity A

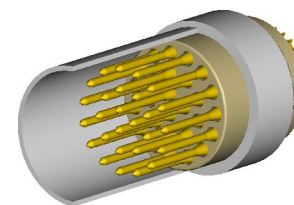

Contact polarity Z

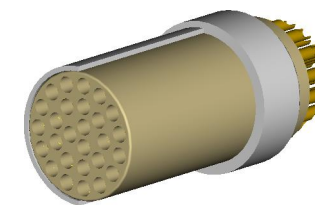

CONTACT CONFIGURATION	Contacts	Solder cup Φ	Crimp cup Φ
105 A Z 051	2	2.03	-
105 A Z 087	2	2.93	-
105 A Z 052	3	2.03	-
105 A Z 053	4	2.03	-

Contact configuration for polarity A (View from B)

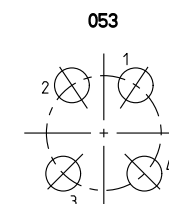
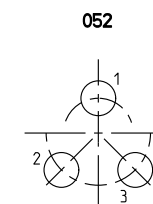
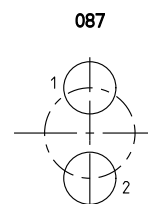
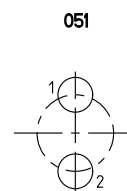

Keying codes (View from F)

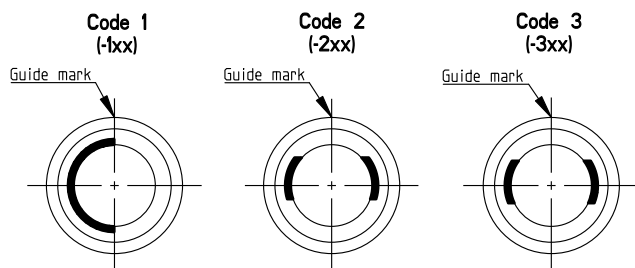

Contact configuration for polarity Z (View from B)

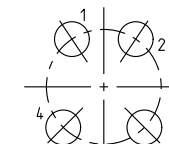
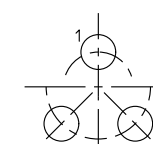
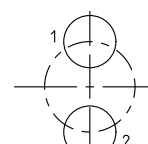
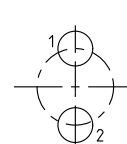

All dimensions in mm

600499

Rev.

2

Pages

1/4

Notes :

- 1) All tolerances resulting from connector assembly are typically $\pm 0.3 \text{ mm}$
- 2) For optimum crimping refer to available crimping manual.
- 3) Max cable diameter below shield

Part number example : SS 105 A102-130

- 4) This torque is a recommended value that may be influenced by the characteristics of the cable. Tests have to be made to evaluate the exact value. To secure the back nut, we recommend the use of thread locking adhesive.

fischer

www.fischerconnectors.com

Information provided herein is believed to be accurate at time of publishing. Fischer Connectors reserves the right to make modifications on products for continuous improvement without prior notice.

SS/SSC 105 Multipole Plugs

All dimensions see note 1)

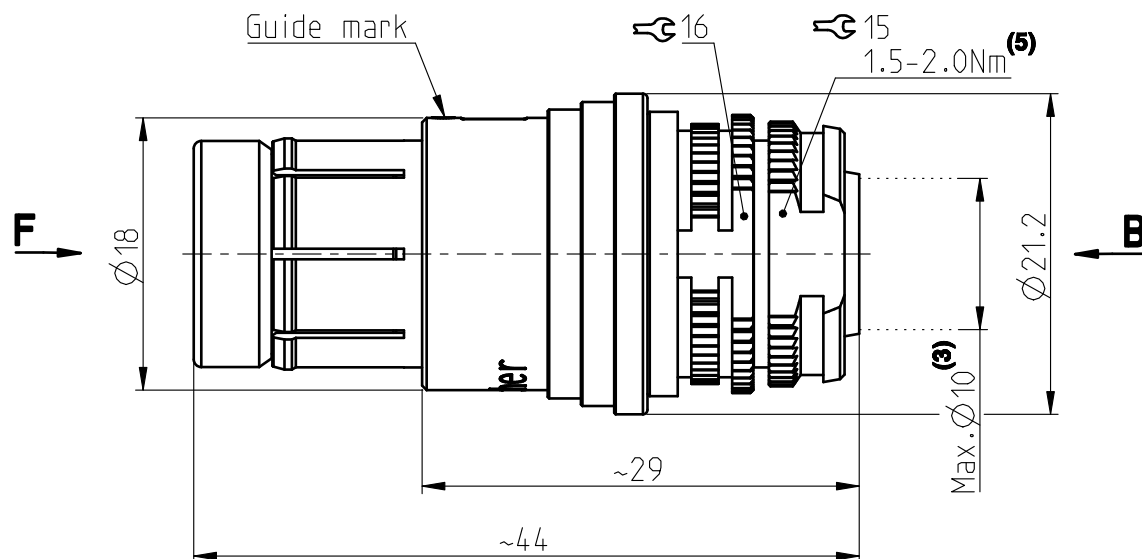

Contact polarity A

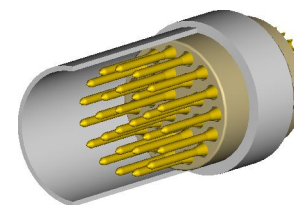

Contact polarity Z

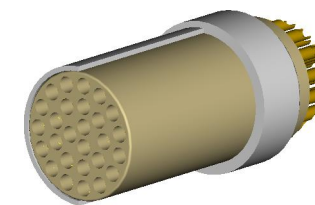

CONTACT CONFIGURATION	Contacts	Solder cup Ø	Crimp cup Ø ⁽²⁾
105 A Z 054	7	1.18/2.03	-
105 A Z 067	8	1.18	-
105 A Z 124	8	1.18/2.48	-
105 A Z 101	9	1.18/2.03	-

Contact configuration for polarity A (View from B)

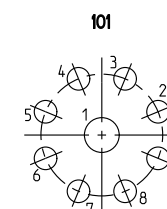
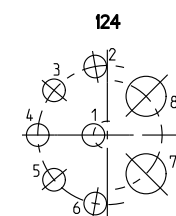
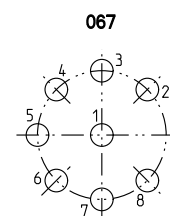
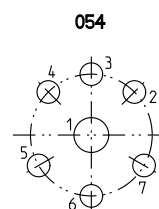

Keying codes (View from F)

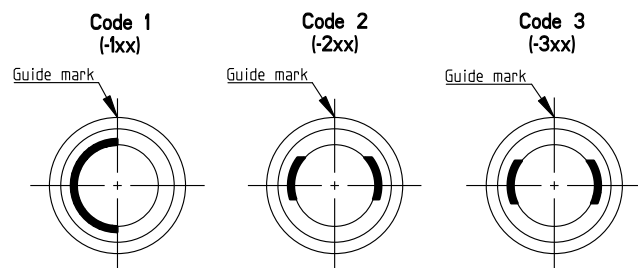

Contact configuration for polarity Z (View from B)

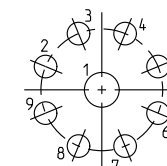
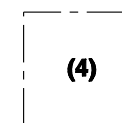
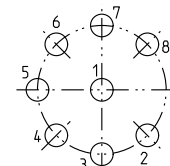
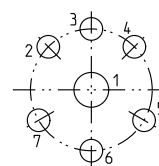

All dimensions in mm

600499

Rev.

2

Pages

2/4

Notes :

- 1) All tolerances resulting from connector assembly are typically $\pm 0.3\text{mm}$
- 2) For optimum crimping refer to available crimping manual.
- 3) Max cable diameter below shield
- 4) Please contact us.

Part number example : SS 105 A102-130

- 5) This torque is a recommended value that may be influenced by the characteristics of the cable. Tests have to be made to evaluate the exact value. To secure the back nut, we recommend the use of thread locking adhesive.

fischer

www.fischerconnectors.com

SS/SSC 105 Multipole Plugs

All dimensions see note 1)

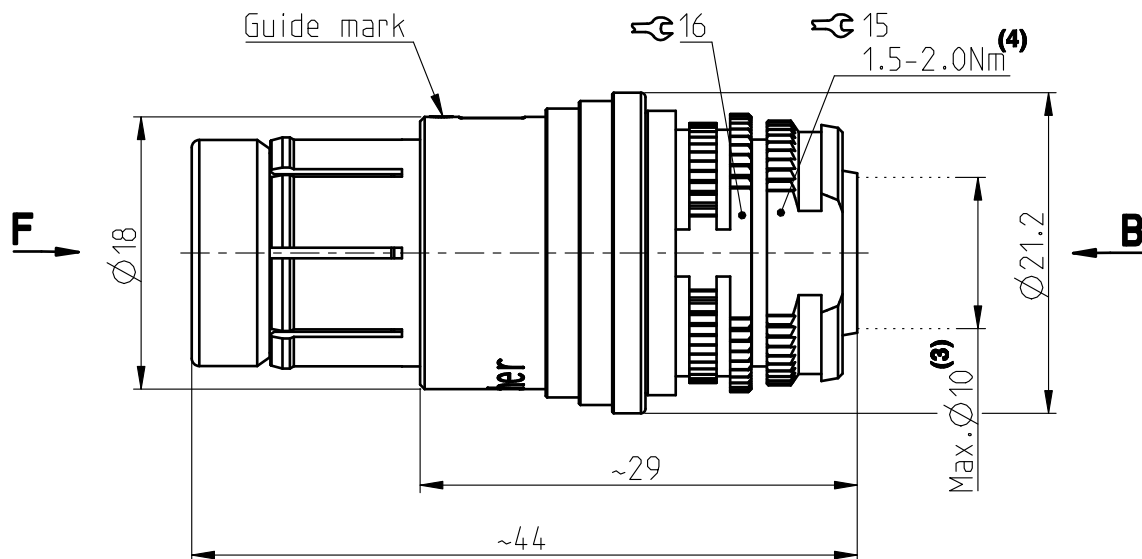

Contact polarity A

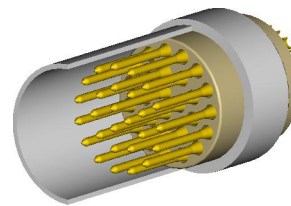

Contact polarity Z

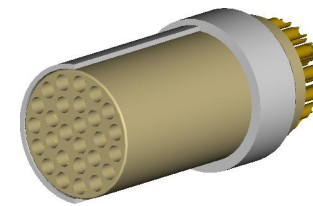

CONTACT CONFIGURATION	Contacts	Solder cup \varnothing		Crimp cup \varnothing
105 A Z 062	10	1.18		1.18
105 A Z 069	12	1.18		-
105 A Z 104	13	0.79/1.18		-
105 A Z 110	16	0.79/1.86		-

Contact configuration for polarity A (View from B)

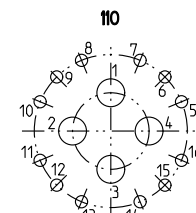
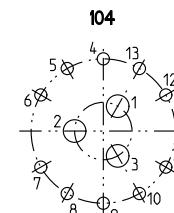
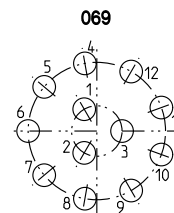
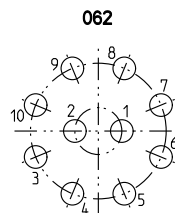

Keying codes (View from F)

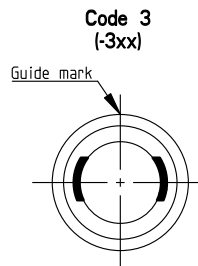
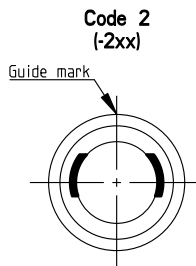
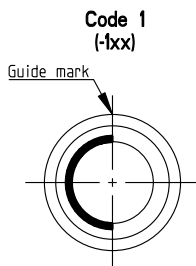

Contact configuration for polarity Z (View from B)

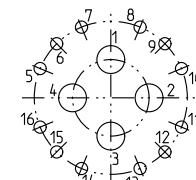
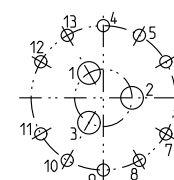
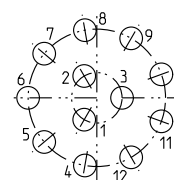
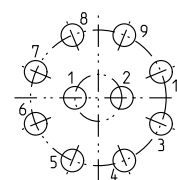

All dimensions in mm

600499

Rev.

2

Pages

3/4

Notes :

Notes : Part number example : SS 105 A102-130
 1) All tolerances resulting from connector assembly are typically $\pm 0.3\text{mm}$
 2) For optimum crimping refer to available crimping manual.
 3) Max cable diameter below shield

Part number example : SS 105 A102-130

4) This torque is a recommended value that may be influenced by the characteristics of the cable.
Tests have to be made to evaluate the exact value.
To secure the back nut, we recommend the use of thread locking adhesive.

4) This torque is a recommended value that may be influenced

by the characteristics of the cable.

To secure the back nut, we recommend the use of thread locking adhesive.



www.fischerconnectors.com

Information provided herein is believed to be accurate at time of publishing. Fischer Connectors reserves the right to make modifications on products for continuous improvement without prior notice.

SS/SSC 105 Multipole Plugs

All dimensions see note 1)

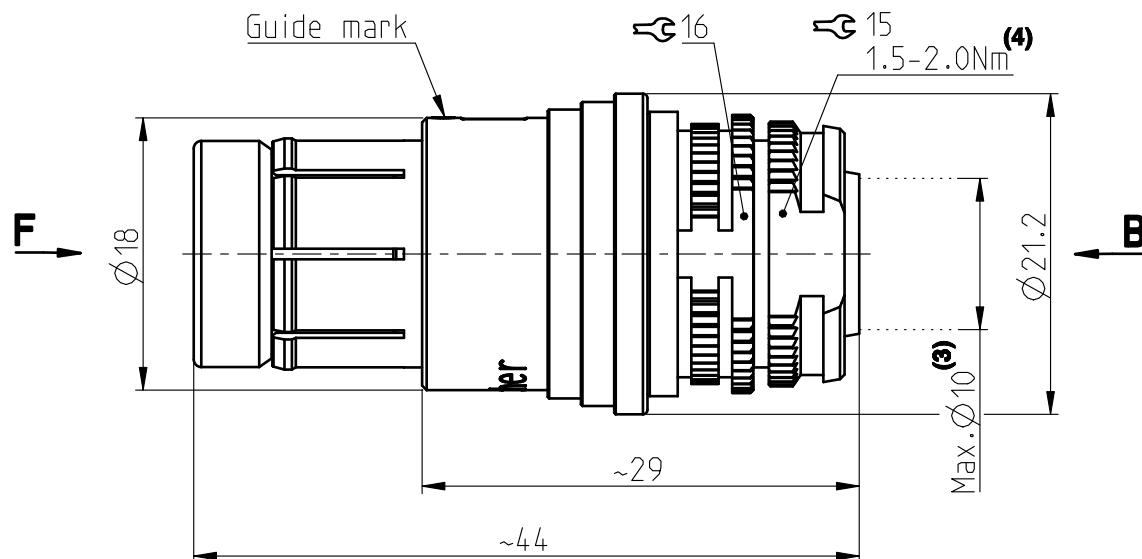

Contact polarity A

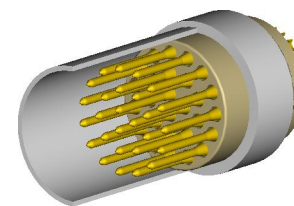

Contact polarity Z

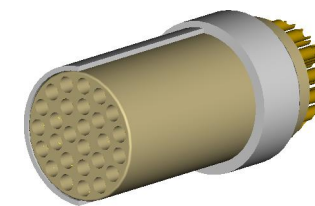

CONTACT CONFIGURATION	Contacts	Solder cup \varnothing	Crimp cup ⁽²⁾ \varnothing
105 A Z 058	15	0.79	0.80
105 A Z 038	18	0.79	0.80
105 A Z 093	24	0.79	-
105 A Z 102	27	0.79	0.60

Contact configuration for polarity A (View from B)

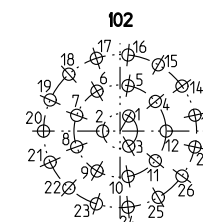
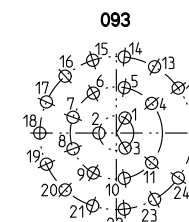
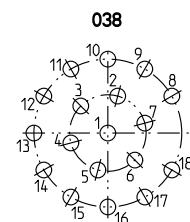
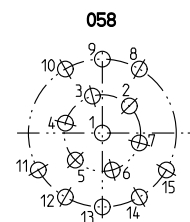

Keying codes (View from F)

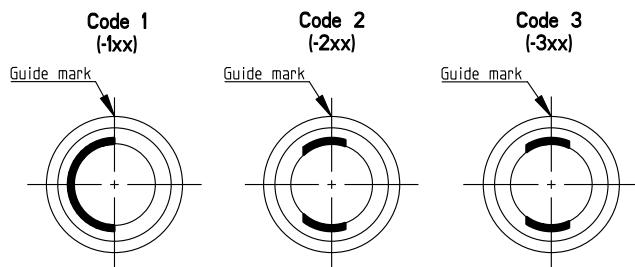

Contact configuration for polarity Z (View from B)

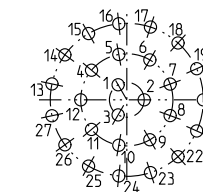
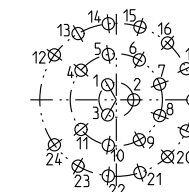
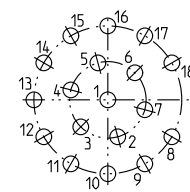
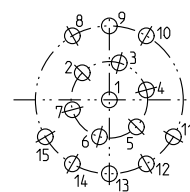

All dimensions in mm

600499

Rev.

2

Pages

4/4

Notes :

Part number example : SS 105 A102-130
 1) All tolerances resulting from connector assembly are typically $\pm 0.3\text{mm}$
 2) For optimum crimping refer to available crimping manual.
 3) Max cable diameter below shield

4) This torque is a recommended value that may be influenced by the characteristics of the cable.
 Tests have to be made to evaluate the exact value.
 To secure the back nut, we recommend the use of thread locking adhesive.

fischer

www.fischerconnectors.com

Information provided herein is believed to be accurate at time of publishing. Fischer Connectors reserves the right to make modifications on products for continuous improvement without prior notice.